

# RPFTF

Pendulum room humidity and temperature sensor

## RANGE

0~95 %  
-5~60 °C

## POWER

15 ... 36  
V DC

## OUTPUT

4-20mA  
0~10V

Approvals



Messtechnik  
Made in Germany

## SPECIFICATION

<b>MODEL</b>	RPFTF
<b>OUTPUT</b>	DC4-20mA 0-10V
<b>POWER</b>	15 to 36V DC
<b>MEASURING RANGE</b>	Humidity : 0 to 100% r.H. Temperature : -35 to 35, -35 to 75, 0 to 50, 0 to 80 °C
<b>OPERATING RANGE</b>	Humidity : 0 to 95% r.H. [ without formation of dew ] Temperature : -35 to 80 °C
<b>DEVIATION</b>	Humidity : typically ±2% r.H. [ 20...80% r.H. ] at +25 °C, otherwise ±3% r.H. Temperature : typically ±0.4K at +25 °C
<b>AMBIENT TEMPERATURE</b>	-5 ... +60 °C, non-precipitating
<b>SENSOR PROTECTION</b>	plastic sinter filter, Φ 16mm, L=35mm metal sinter filter, Φ 16mm, L=32mm*
<b>PROTECTIVE TUBE</b>	stainless steel, Φ=16mm, L=142mm
<b>CABLE CONNECTION</b>	approx.2m
<b>CABLE GLAND</b>	M16x1.5, max. inner diameter 10.4mm
<b>PROTECTION TYPE</b>	IP65 [ according to EN 60529 ]
<b>ELECTRICAL CONNECTION</b>	3-, or 4-wire connection 0.14 - 1.5 mm <sup>2</sup> , via terminal screws on circuit board

Temperature measuring ranges [ Adjustable ]	DIP	DIP
	1	2
-35 ... +75 °C	ON	ON
-35 ... +35 °C	OFF	OFF
0 ... +50 °C	OFF	ON
0 ... +80 °C	ON	OFF

### Mounting Flange [ Plastic ]

MF-16-K



with display



without display

| CO2 | HUMIDITY | TEMPERATURE | AC | DC | BATTERY | OUTPUT | CONTACT | DISPLAY |

### DIMENSION (mm)

※ 제품의 사양에 따라 변경 될 수 있습니다

without display

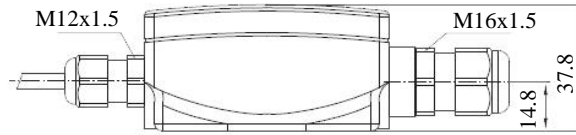
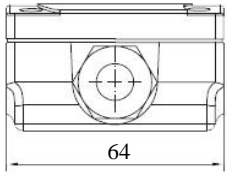

with display

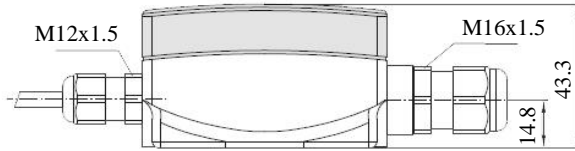
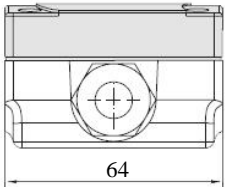

plastic sinter filter [ standard ]

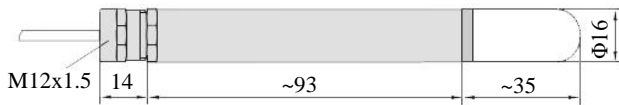

metal sinter filter [ optional ]

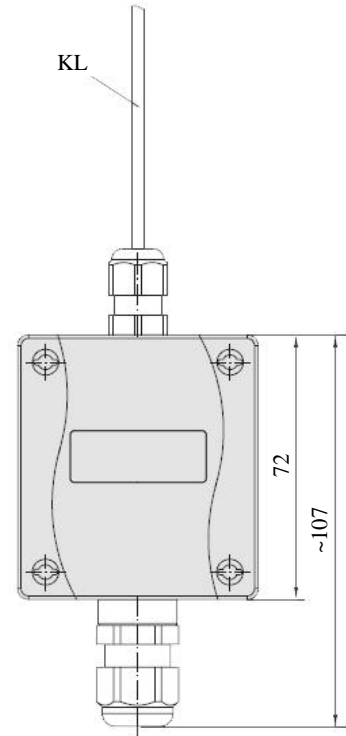
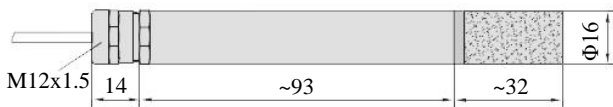

### DIAGRAM

4-20mA 3 or 4-wire

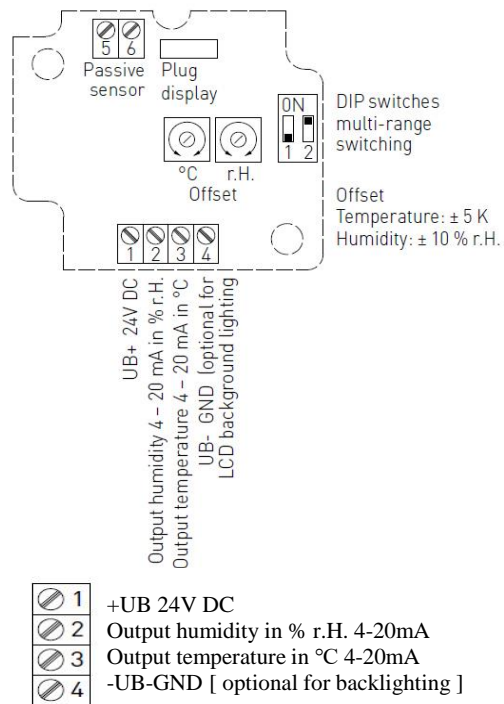



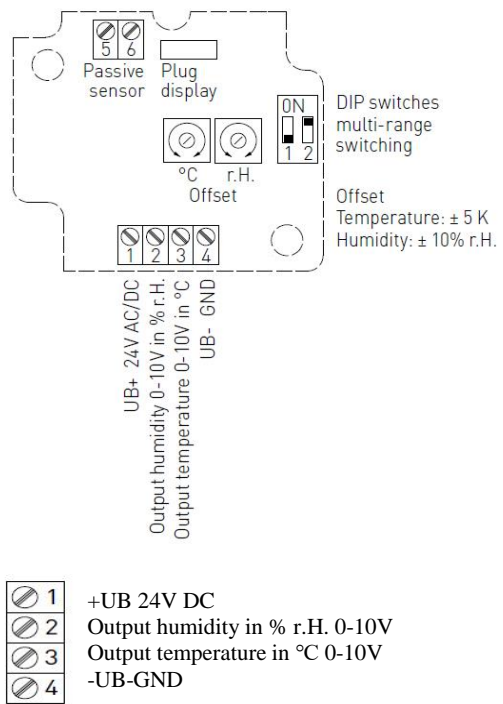

0-10V 4-wire

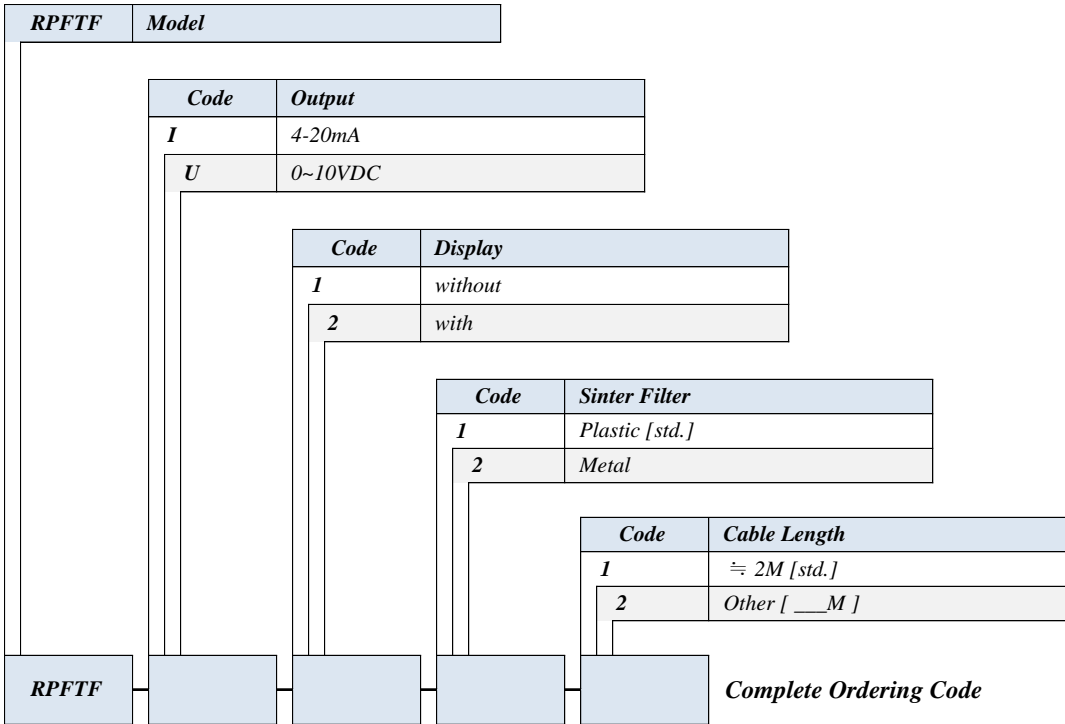

| CO2 | HUMIDITY | TEMPERATURE | AC | DC | BATTERY | OUTPUT | CONTACT | DISPLAY

### Ordering Information



TYPE & IMAGE		
		
RPFTF-I-1-1-1 RPFTF-U-1-1-1	RPFTF-I-2-1-1 RPFTF-U-2-1-1	metal sinter filter [ Optional ]

| CO2 | HUMIDITY | TEMPERATURE | AC | DC | BATTERY | OUTPUT | CONTACT | DISPLAY