

DT110

THREAD TYPE DIAPHRAGM SEAL

Approvals:



RANGE

0 ~ 4 ...
40 bar

SIZE

1/4 ...
1/2 Inch

MEDIA

**Liquid
&
Gas**

SPECIFICATION

| | |
|-------------------------------|--|
| MODEL | DT110 |
| CONNECTION | 1/4", 3/8", 1/2" NPT, PF Male, Female |
| UPPER HOUSING MATERIAL | 316SS |
| LOWER HOUSING MATERIAL | 316SS 316LSS* Hastelloy C276* Tantalum* Titanium* |
| MEMBRANE MATERIAL | 316LSS Hastelloy C276* Tantalum* |
| TEMPERATURE LIMITED | -40 ~ 150 °C Max. 350 °C* [with cooling element] *=-Optional |

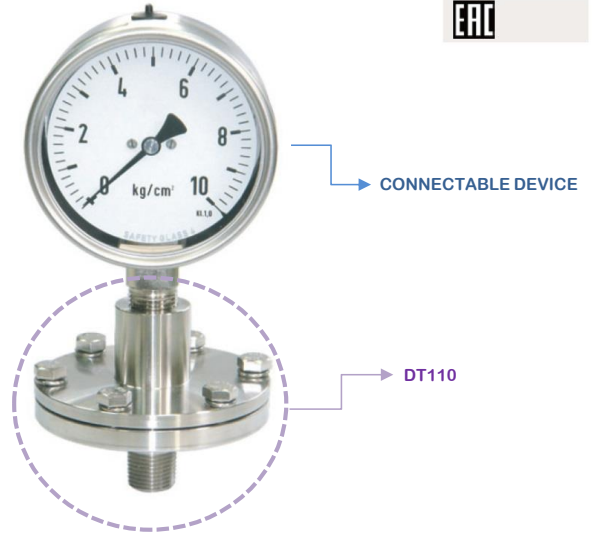

FLOW | PRESSURE | TEMPERATURE | AC | DC | BATTERY | OUTPUT | CONTACT | DISPLAY

SIZE & PRESSURE RANGE

| Membrane Size | 55Φ | 75Φ |
|-----------------|--------|-------------|
| Minimum [bar] | 0 ~ 6 | -1~0, 0 ~ 4 |
| Maximum [bar] | 0 ~ 40 | |

DIMENSION (mm)

| Item | Description of parts |
|------|-----------------------|
| a | Upper housing |
| b | Lower housing |
| c | Membrane |
| d | Instrument connection |
| e | Filling port |
| f | Process connection |
| g | Screw bolt |

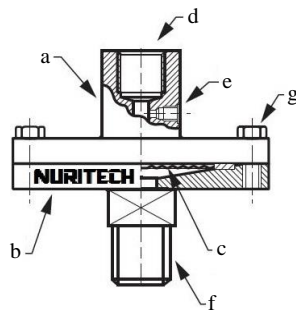



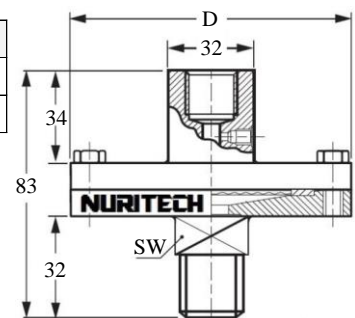



| | Membrane Size | | |
|---|---------------|-----|-----|
| Φ | 55 | 75 | 95 |
| D | 80 | 100 | 120 |



제품의 사양에 따라 변경 될 수 있습니다.

CONNECTABLE DEVICES

| |  |  |  |  |  |  |
|-------------------------------|---|---|---|---|---|---|
| Model | PG | PGS | DPG3500 | DPG3000 | PT3100 | PT5000 |
| Accuracy | ±1.6% F.S. | ±1.0% F.S. | ±1.0% F.S. | ±0.5% F.S. | ±0.5% F.S. | ±0.2% F.S. |
| Gauge outdia. | 60mm | 100mm | 80mm | 75mm | | |
| Output | | | | | DC4-20mA | DC4-20mA |
| Range Unit : bar or kg/cm2 | -1 ~ 0 | -1 ~ 0 | 0 ~ 7 | -1 ~ 0 | -1 ~ 0 | -1 ~ 0 |
| | 0 ~ 4 | 0 ~ 4 | 0 ~ 14 | 0 ~ 7 | 0 ~ 4 | 0 ~ 4 |
| | 0 ~ 6 | 0 ~ 7 | 0 ~ 20 | 0 ~ 35 | 0 ~ 6 | 0 ~ 6 |
| | 0 ~ 10 | 0 ~ 10 | 0 ~ 35 | | 0 ~ 10 | 0 ~ 10 |
| | 0 ~ 16 | 0 ~ 16 | | | 0 ~ 16 | 0 ~ 16 |
| | 0 ~ 25 | 0 ~ 20 | | | 0 ~ 25 | 0 ~ 25 |
| | 0 ~ 40 | 0 ~ 25 | | | 0 ~ 40 | 0 ~ 40 |

| FLOW |
 | PRESSURE |
 | TEMPERATURE |
 | AC |
 | DC |
 | BATTERY |
 | OUTPUT |
 | CONTACT |
 | DISPLAY |



Ordering Information

| DT110 | Model | | | |
|-------|-------------|--------------------------------------|-------------|--------------------------------------|
| | Code | Instrument Connection(Female) | Code | Instrument Connection(Female) |
| | A | 1/4" BSP | D | 3/8" NPT |
| | B | 1/4" NPT | E | 1/2" BSP |
| | C | 3/8" BSP | F | 1/2" NPT |
| | Code | Membrane size | | |
| | B | ø55 | | |
| | C | ø75 | | |
| | D | ø95 | | |
| | Code | Process Connection | Code | Process Connection |
| | 1 | 1/4" BSP | 5 | 1/2" BSP |
| | 2 | 1/4" NPT | 6 | 1/2" NPT |
| | 3 | 3/8" BSP | 7 | Option |
| | 4 | 3/8" NPT | | |
| | Code | Thread | | |
| | M | Male | | |
| | F | Female | | |
| | Code | Upper housing material | | |
| | S | SS316 [std.] | | |
| | O | Option | | |
| | Code | Lower housing material | | |
| | S | SS316 [std.] | | |
| | O | Option | | |
| | Code | Membrane material | | |
| | 1 | SS316L | | |
| | 2 | Hastelloy C276 | | |
| | 3 | Tantalum | | |
| | 4 | Option | | |
| | Code | Connectable Devices | | |
| | P | PG (fill range) | | |
| | PS | PGS (fill range) | | |
| | D35 | DPG3500 (fill range) | | |
| | D30 | DPG3000 (fill range) | | |
| | P3 | PT3100 (fill range) | | |
| | P5 | PT5000 (fill range) | | |
| | Code | Test Certi. | | |
| | Y | Issue. | | |
| | N | None. | | |

| FLOW |
 | PRESSURE |
 | TEMPERATURE |
 | AC |
 | DC |
 | BATTERY |
 | OUTPUT |
 | CONTACT |
 | DISPLAY |